

ozito

12V PORTABLE PRESSURE PUMP

600 L/H FLOW

INSTRUCTION MANUAL

SPECIFICATIONS

Voltage:	12V DC
Current:	4.5A
Working Pressure:	17psi
Max. Flow Rate:	10 litres/min
Max. Lift:	1.5m
Max. Head:	10m approx.
Inlet/Outlet Size:	12.7mm (1/2")
Water Temp:	5°C - 45°C
Weight:	1.8kg

ozito.com.au

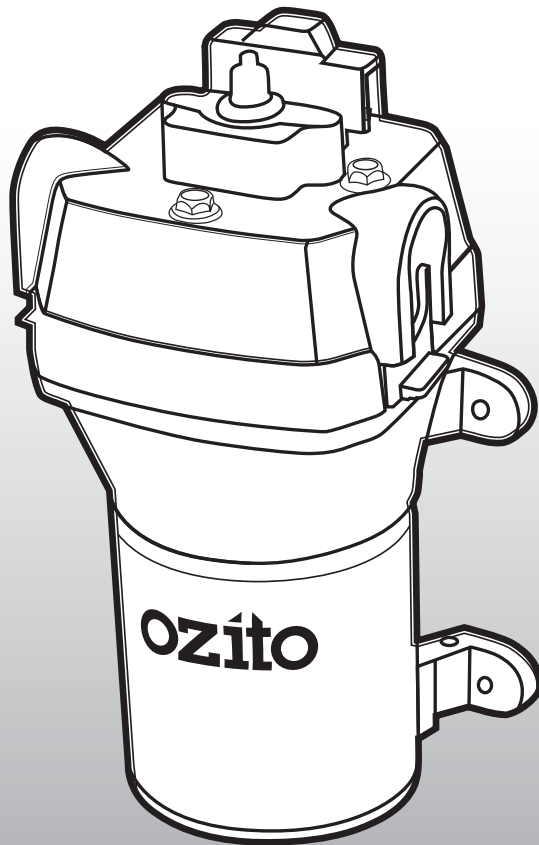

WHAT'S IN THE BOX

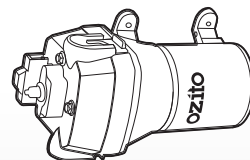

12V Pressure Pump

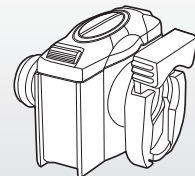

Stainless Steel Filter



3x Inlet/Outlet Adaptors

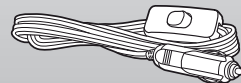

2.1m Cord with On/Off
Switch & 12V DC Plug

3 YEAR REPLACEMENT WARRANTY

PTP-012A

KNOW YOUR PRODUCT

PRESSURE PUMP

- 1 Pressure Switch
- 2 Water Outlet
- 3 Water Inlet
- 4 Upper Housing
- 5 Slide Locking Clip
- 6 Motor Body
- 7 Mounting Feet

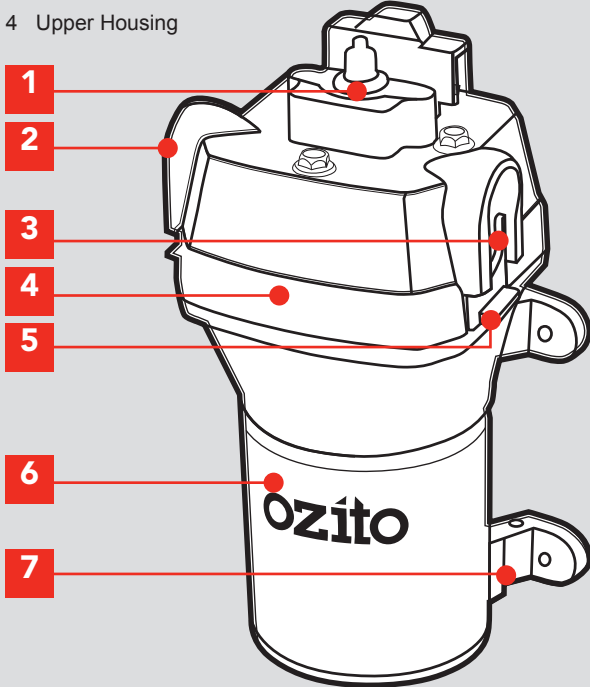

STAINLESS STEEL FILTER

- 8 Filter Cap
- 9 Filter Outlet
- 10 Filter Inlet
- 11 12V DC Plug
- 12 On/Off Switch
- 13 Power Cord Connector

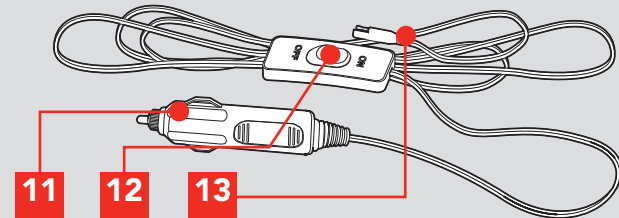
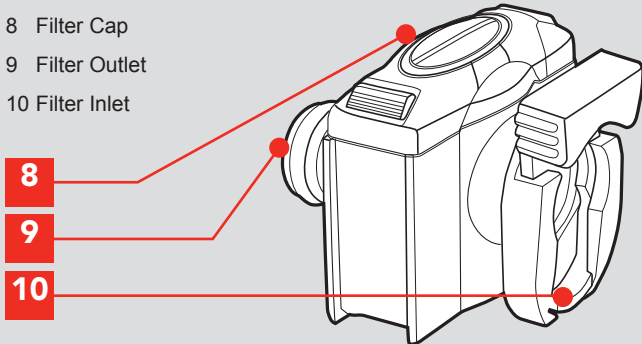

ONLINE MANUAL

Scan this QR Code with your mobile device to take you to the online manual.



SETUP & PREPARATION

1. STAINLESS STEEL FILTER



WARNING: ENSURE THE TOOL IS SWITCHED OFF AND DISCONNECTED FROM THE POWER SUPPLY BEFORE PERFORMING ANY OF THE FOLLOWING STEPS.

The pump can be used with or without the stainless steel filter. The filter should be used when the water being pumped contains contaminants.

- 1 Push the slide locking clip on the pump inlet down and ensure the water inlet is clear.

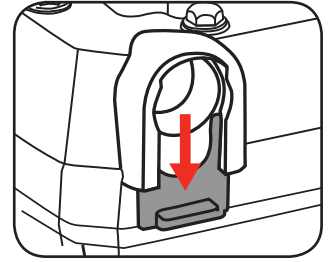

- 2 Push the filter unit firmly into the water inlet of the pump.

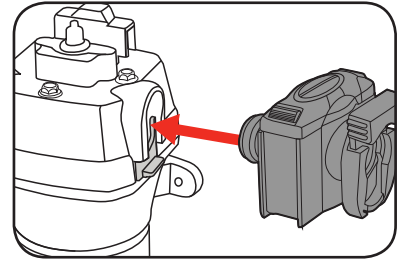

- 3 Lock the unit in place by pushing the slide locking clip back up.

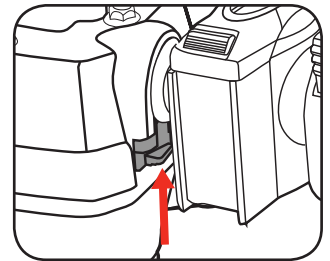

3

 YEAR REPLACEMENT WARRANTY

2. ATTACHING A HOSE

Attaching Hose to the Water Inlet

- 1 Raise the slide locking clip on the inlet side of the filter.

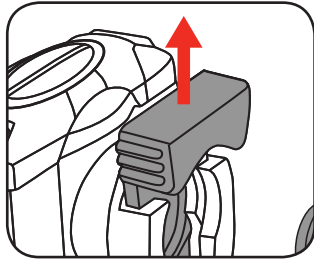

- 2 Place the male hose adaptor in the inlet of the filter and secure by lowering the slide locking clip.

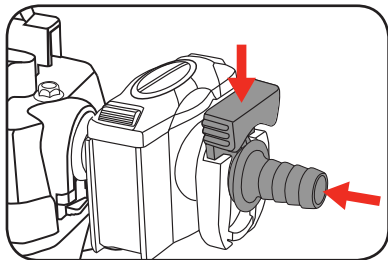

- 3 Attach a suitable hose to the male adaptor, fit hose clamps (not included) and tighten.

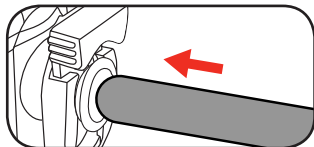

WARNING: THE INPUT HOSE SHOULD BE LOW ENOUGH IN THE WATER TO ENSURE THAT IF THE WATER FALLS, THE PUMP WILL CONTINUE TO OPERATE CORRECTLY.

Attaching Hose to the Outlet

- 1 Lower the slide locking clip on the water outlet.

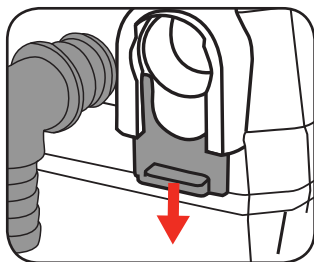

- 2 Place the male hose adaptor in the outlet and secure by lifting the slide locking clip.

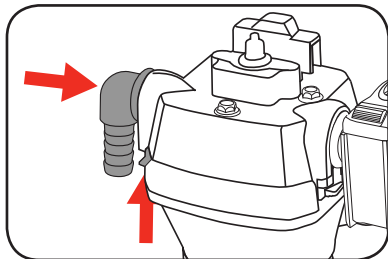

- 3 Attach a suitable hose to the outlet adaptor, fit hose clamps (not included) and tighten.

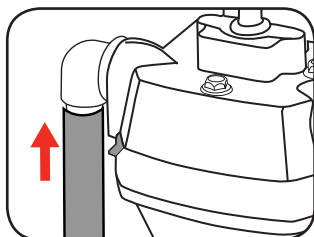

3. TURNING ON & OFF

The pump comes supplied with an auxiliary cable. The 12V DC plug on the auxiliary cable enables the pump to be powered from a standard 12V power outlet found in cars, boats and some generators.

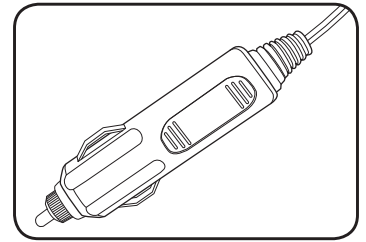

- 1 Attach the 12V power cable adaptor to the pump.

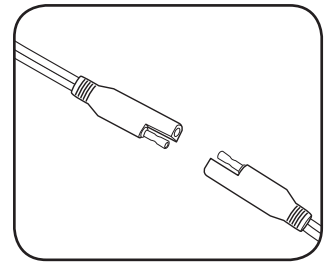

- 2 Plug the 12V adaptor into a suitable power source.

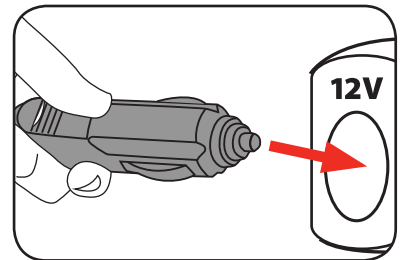

IMPORTANT! ENSURE THAT ALL ELECTRICAL WIRING IS SECURED IN PLACE WITH THE CONNECTIONS WELL AWAY FROM THE WATER.

- 3 Switch the on/off switch into the on position.

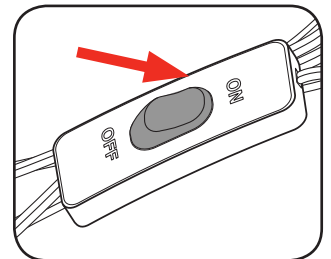

- 3 To turn the pump off switch the on/off switch into the off position.

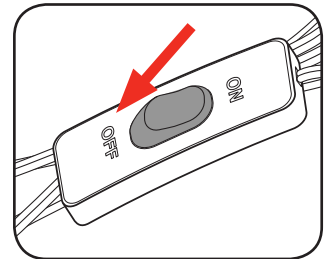

4. INSTALLATION

Installation Guide for Portable Applications

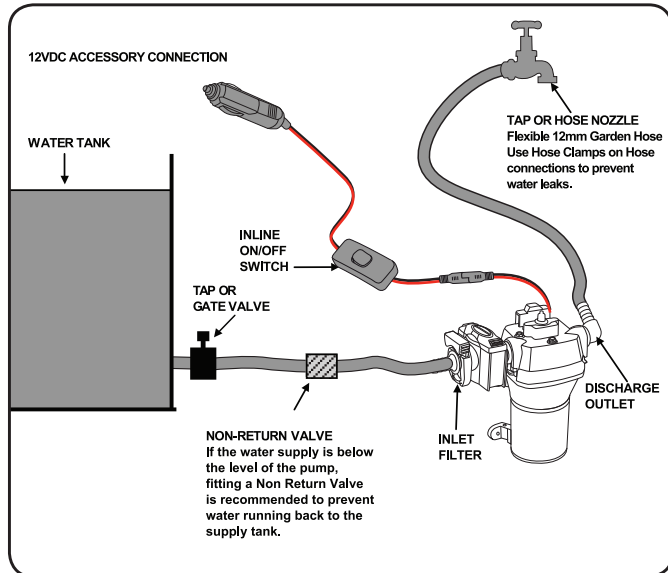

Note: When not using the supplied auxiliary cable (ie. when setting up a fixed installation), it is recommended that you use a 10 Amp fuse and a 12V/10 Amp power supply.

Mounting

The following should be considered to achieve optimum pump operation.

- The pump can be mounted at the same level or below the water supply. It may be positioned above the water supply if need, as it is capable of a 1.8m vertical prime. Horizontal inlet will allow priming to 9m.
- The pump can be mounted in any position. If mounting the pump vertically, the pump head should be in the down position for optimum performance.
- The Mounting Feet are intended to isolate the pump from mounting surface; over tightening, flattening, or use of oversized screws will reduce the ability to isolate vibration and noise.

Positioning the Hose

Position the input hose so that it rises from the water drawing source to the pump. Avoid positioning the input hose higher than the pump, as this would delay the escape of air bubbles from the input hose and impede the priming process.

We recommend at least 0.3m of 12.7mm I/D flexible hose to the inlet and outlet connections. Use hose clamps on hose connections to prevent water leaks.

Note: If the water supply is below the level of the pump, fitting a Non Return Valve is recommended to prevent water running back to the water supply.

Installation Guide for Permanent Applications

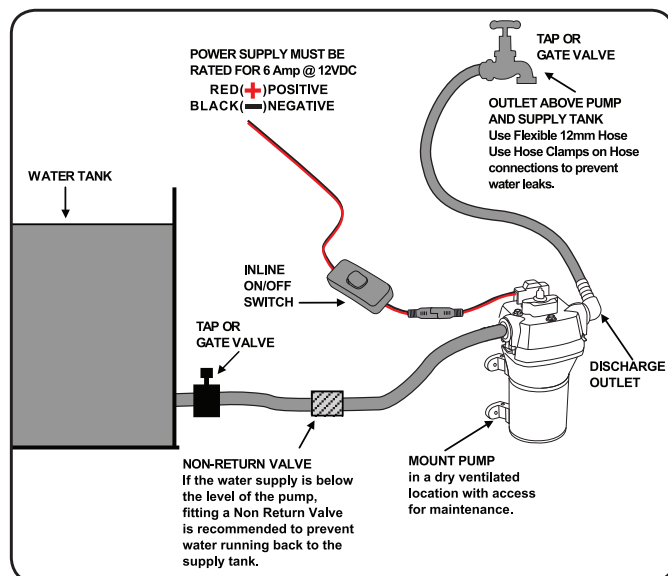

WARNING: THE INPUT HOSE SHOULD BE LOW ENOUGH IN THE WATER TO ENSURE THAT IF THE WATER FALLS, THE PUMP WILL CONTINUE TO OPERATE CORRECTLY. ENSURE THAT THIS IS CHECKED WHEN IN OPERATION.

NOTE: A leaking hose or pipe will draw in air and therefore not draw in any water.

MAINTENANCE

5. MAINTENANCE & STORAGE

Cleaning the Filter Unit



WARNING: ENSURE THE TOOL IS SWITCHED OFF AND DISCONNECTED FROM THE POWER SUPPLY BEFORE PERFORMING ANY OF THE FOLLOWING STEPS.

- 1 Press in the locking tabs on each side of the filter to release the filter cap.

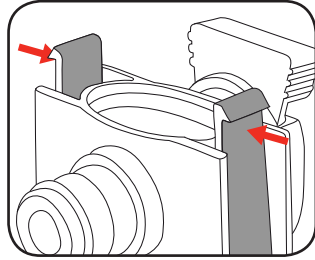

- 2 Remove the filter cap and clean debris from the filter using a light brush and warm soapy water.

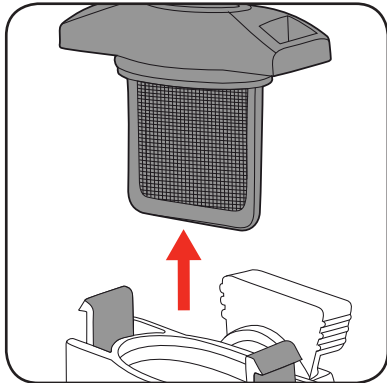

- 3 Once clean, push the filter cap back onto the filter tabs until it clicks into place.

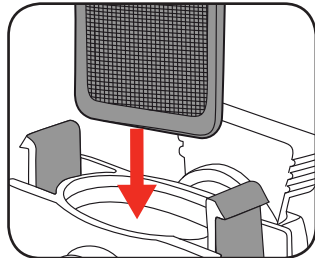

Maintenance

Regularly check the pump to be sure that the filter base and impeller are not clogged with debris. Follow the instruction in this manual to clean the filter if clogged.

Storage

The pump itself is not affected by freezing temperatures . However, if the pump is embedded in ice or surrounded by ice, it cannot be used. Never turn the pump on if it is embedded in or surrounded by ice

TROUBLESHOOTING

Symptom	Possible Cause	Cure
Pump not working	Blown fuse	Replace fuse in 12V DC Plug
Reduced Flow	Blockage	Clean debris from around impeller and clean the filter.
	Water line clogged	Clean out hose by back flushing.
	Low battery voltage	Check battery condition and charge if necessary.
	Kinked water hose	Change to a hose that does not kink at the bends.
No water pumped	Wire connections	Make sure wire connections are not corroded. Check to be sure no wire joins are hanging down into the water.
	Float switch failure. (if connected).	Lift end of float switch up - if pump runs, switch is OK. If pump does not run, turn manual switch to on position - if pump runs, automatic switch has failed.
Pump won't shut off.	Something under the float (if connected)	Clean under the float to make sure debris is not holding the float up.
	Stuck float (if connected).	Check to see that the float switch moves freely. If float action appears sluggish and/or the float does not move freely, intermittent or sporadic operation of the pump may occur. This condition is usually the result of oil and/or dirt accumulating in and around the movable parts of the switch. To correct, clean the switch, checking for smooth and free operation of the float. Repeat if necessary
	IMPORTANT. Switch mounted too low	If the pump is sucking air and the automatic switch has not reached the OFF position, then the switch may be mounted too low for the pump and should be reinstalled at least 6mm higher than the pump base.

DESCRIPTION OF SYMBOLS

V	Volts	W	Watts
DC	Direct current	mA	Milliamperes
L/H	Litres per hour	IP	Ingress protection from water
	Regulator compliance mark	PVC	Polyvinyl chloride
	Warning		Read instruction manual

GENERAL PUMP SAFETY WARNINGS

 **WARNING!** Read all safety warnings and all instructions. Failure to follow the warnings and instructions may result in electric shock, fire and/or serious injury.

Save these instructions

1. Work area

- a. **Keep work area clean and well lit.** Cluttered or dark areas invite accidents.
- b. **Do not operate pumps in explosive atmospheres, such as in the presence of flammable liquids, gases or dust.** Pumps create sparks which may ignite the dust or fumes.
- c. **Keep children and bystanders away while operating a pump.** Distractions can cause you to lose control.

2. Electrical safety

When using 12 Volt equipment, basic safety precautions, including the following, should always be followed to reduce risk of fire, electric shock, personal injury and material damage.

- a. **Do not abuse the cord. Never use the cord for carrying, pulling or unplugging the pump. Keep cord away from heat, oil, sharp edges or moving parts.** Damaged or entangled cords increase the risk of electric shock.
- b. **The electric motor has been designed for 12V only.** Always check that the power supply corresponds to the voltage on the rating plate.

3. Personal safety

- a. **Stay alert, watch what you are doing and use common sense when operating a pump. Do not use a pump while you are tired or under the influence of drugs, alcohol or medication.** A moment of inattention while operating pumps may result in serious personal injury.
- b. **Avoid accidental starting. Ensure the switch is in the off position before plugging in.** Carrying pumps with your finger on the switch or plugging in pumps that have the switch on invites accidents.

- c. **Remove any adjusting key or wrench before turning the pump on.** A wrench or a key left attached to a rotating part of the pump may result in personal injury.
- d. **Dress properly. Do not wear loose clothing or jewellery. Keep your hair, clothing and gloves away from moving parts.** Loose clothes, jewellery or long hair can be caught in moving parts.

4. Pump use and care

- a. **Disconnect the plug from the power source before making any adjustments, changing accessories, or storing pumps.** Such preventive safety measures reduce the risk of starting the pump accidentally.
- b. **Maintain pumps. Check for misalignment or binding of moving parts, breakage of parts and any other condition that may affect the pumps operation. If damaged, have the pump repaired before use.** Many accidents are caused by poorly maintained pumps.
- c. **Use the pump, accessories and tool bits etc., in accordance with these instructions and in the manner intended for the particular type of pump, taking into account the working conditions and the work to be performed.** Use of the pump for operations different from intended could result in a hazardous situation.

5. Service

- a. **Have your pump serviced by a qualified repair person using only identical replacement parts.** This will ensure that the safety of the pump is maintained.

PORTABLE PRESSURE PUMP SAFETY WARNINGS

 **CAUTION:** Not intended for cleaning and other maintenance of swimming pools.

 **WARNING!** This product is intended for pumping water in a home domestic application.

Do not use it for corrosive, abrasive, explosive or dangerous liquids. Fluids other than water will damage the water pump and/or create a fire hazard.

 **WARNING!** This product is not suitable for use with drinking (potable) water.

This appliance is not intended for use by persons (including children) with reduced physical, sensory or mental capabilities, or lack of experience and knowledge, unless they have been given supervision or instruction concerning use of the appliance by a person responsible for their safety.

Children should be supervised to ensure that they don't play with the appliance.

- Ensure the pressure pump is disconnected from mains power when installing
- Do not install or operate the water pump in an explosive environment or near flammable material.
- Do not operate the water pump without liquid.
- Do not run the water pump dry.

 **WARNING!** The water pump together with associated pipework operate under pressure.

Do not disconnect water pump or pipework until internal pressure has been released. Failure to do this could result in personal injury and damage to property.

- Avoid inserting hands into the inlets/outlets of the water pump while it is connected to mains power.
- Before using the water pump, always inspect it visually. Do not use the pump if it is cracked and/or damaged. If the water pump is damaged, contact customer service.

Never work or perform maintenance on the pump without first making sure it has been disconnected from the mains power.

Pollution of the liquid could occur due to leakage of lubricants.

 **IMPORTANT:** The electrical connections must always be made in a dry area. Make sure that electrical connections are protected from inundations. Protect the plug and the power cable from heat, oil or sharp edges. If damaged, the power cable must be replaced by a qualified electrician.

CARING FOR THE ENVIRONMENT



Pumps that are no longer usable should not be disposed of with household waste but in an environmentally friendly way. Please recycle where facilities exist. Check with your local council authority for recycling advice.



Recycling packaging reduces the need for landfill and raw materials. Reuse of recycled material decreases pollution in the environment. Please recycle packaging where facilities exist. Check with your local council authority for recycling advice.

SPARE PARTS

Spare parts can be ordered from the Special Orders Desk at your local Bunnings Warehouse.

For further information, or any parts not listed here, visit www.ozito.com.au or contact Ozito Customer Service:

Australia 1800 069 486

New Zealand 0508 069 486

E-mail: enquires@ozito.com.au

WARRANTY

IN ORDER TO MAKE A CLAIM UNDER THIS WARRANTY YOU MUST RETURN THE PRODUCT TO YOUR NEAREST BUNNINGS WAREHOUSE WITH YOUR BUNNINGS REGISTER RECEIPT. PRIOR TO RETURNING YOUR PRODUCT FOR WARRANTY PLEASE TELEPHONE OUR CUSTOMER SERVICE HELPLINE:

Australia 1800 069 486

New Zealand 0508 069 486

TO ENSURE A SPEEDY RESPONSE PLEASE HAVE THE MODEL NUMBER AND DATE OF PURCHASE AVAILABLE. A CUSTOMER SERVICE REPRESENTATIVE WILL TAKE YOUR CALL AND ANSWER ANY QUESTIONS YOU MAY HAVE RELATING TO THE WARRANTY POLICY OR PROCEDURE.

The benefits provided under this warranty are in addition to other rights and remedies which are available to you at law.

Our goods come with guarantees that cannot be excluded at law. You are entitled to a replacement or refund for a major failure and for compensation for any other reasonably foreseeable loss or damage. You are also entitled to have the goods repaired or replaced if the goods fail to be of acceptable quality and the failure does not amount to a major failure.

Generally you will be responsible for all costs associated with a claim under this warranty, however, where you have suffered any additional direct loss as a result of a defective product you may be able to claim such expenses by contacting our customer service helpline above.

3 YEAR REPLACEMENT WARRANTY

Your product is guaranteed for a period of **36 months from the original date of purchase**. If a product is defective it will be replaced in accordance with the terms of this warranty. Warranty excludes consumable parts, for example: o-rings, bearings, seals, gaskets, drain caps, and all accessories.

WARNING

The following actions will result in the warranty being void.

- If the pump has been operated on a supply voltage other than that specified on the tool.
- If the pump shows signs of damage or defects caused by or resulting from abuse, accidents or alterations.
- Failure to perform maintenance as set out within the instruction manual.
- If the pump is disassembled or tampered with in any way.
- Professional, industrial or high frequency use.